

ONOAYO

USER MANUAL

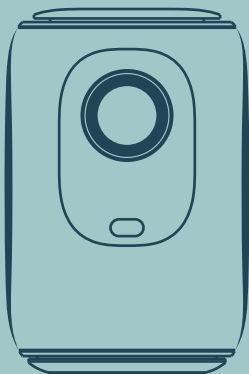

AY2Pro MINI VIDEO PROJECTOR

SHARE MOMENTS, SHARE ONOAYO

✉ support_us@onoayo.net

✉ support_jp@onoayo.net

🌐 www.hdprojectortech.com

W240111

EN 001~028

CONTENTS

TROUBLESHOOTING	001
PACKING LIST	003
FUNCTION OVERVIEW	004
REMOTE CONTROL	006
QUICK START	007
INPUT SOURCE	008
-HDMI Connection.....	008
-USB Connection.....	009
-Speaker/Headphones Connection	010
WIRELESS PROJECTION	011
SETTINGS.....	016
BLUETOOTH CONNECTION.....	017
PROJECTOR IMAGE SETTINGS	020
-Installation Method.....	020
-Auto $\pm 50^\circ$ Vertical Keystone Correction	022
-Manual $\pm 50^\circ$ Vertical Keystone Correction	022
-Electric-focus	023
-Zoom Function.....	024
INSTALLATION	025
-Projection Distance and Size.....	025
-Projector Installation	026
PROJECTOR SPECIFICATIONS	027
FCC STATEMENT.....	028

TROUBLE SHOOTING

Our high-qualified customer services team is waiting to hear from you and answer any of your questions 24 hours a day and 7 days a week. We are happy to receive your message about the problems you met so that we can help you to get out of the trouble. You can contact us through email.

US: Support_us@onoayo.net

Q: Where can I find the instructional videos on how to set up the projector?

A: We have prepared detailed operation videos on YouTube, which contains almost every step of operating the projector, like wifi connection, wired connection and so on. Just search "Onoayo" on YouTube and you will find it.

Q: I received the projector but it has no remote control. Could you send it to me?

A: If the product you receive is missing any accessories, please let us know what accessory do you miss. We will send them to you as soon as possible.- Just contact us via our e-mail:Support_us@onoayo.net

Q: I can't find the focus ring on the projector,how can I adjust the focus?

A: This mini projector support electric-focus with remote control,just need to press the "F+"&"F-" on the remote.Note: Projector and screen/wall must be in effective distance.

Q: The remote control is unresponsive.

A: ①Make sure remote points at IR receiver directly.

②Do not cover IR receiver.

③Make sure you have put the battery in,this remote control does not come with batteries.

Q:I don't need the projector lanyard,how can I remove it?

A: The buckle connecting the lanyard has an opening that can be opened and closed. You only need to open the buckle to remove the lanyard.

Q: The projector is scratched, did I receive a second-hand product?

A: We promise that our projector has been carefully checked before shipping. However the long time and distance shipping may cause damage to the projector. Plz don't worried about that and you can contact us to get a satisfactory solution.

Q: I can't play Netflix video on the projector, why?

A: There are quite a few video platforms like Netflix, Disney+ and Hulu are under HDCP copyright protection, and thus do not support being displayed on a projector, this is the same situation for all projectors. You would need a TV stick to enjoy these video platforms.

Q: Up Side Down Images.

A: Enter [Set], then enter [projector setting] to flip the projection image.

Q: I contact the customer service team as suggested, but has not received any reply. Why?

A: We promise that we will reply to all the emails within 24 hours. If you haven't received any reply from us more than one day, then maybe our email has been blocked or has gone to the spam email box. Please send us email again or contact us by Whatsapp or Facebook.

Q: Hello,could you tell me what the size of the mounting screw is at the bottom of the projector? I am struggling to find a stand.

A: The size of the mounting screw is M4.

PACKING LIST

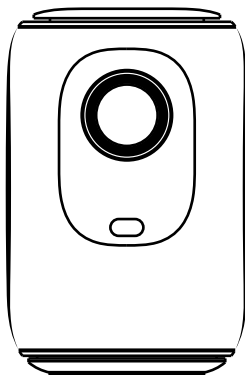

AY2Pro

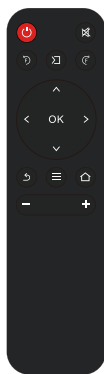

Remote



User Manual



HD Cable

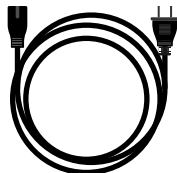

Power Cable

NOTICE

Recommended

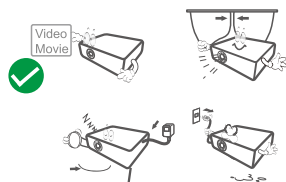

Not Recommended

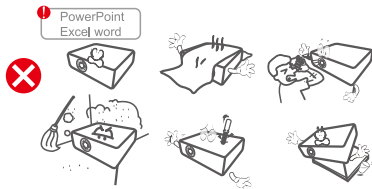

FUNCTION OVERVIEW

Top View

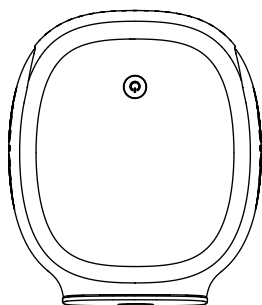

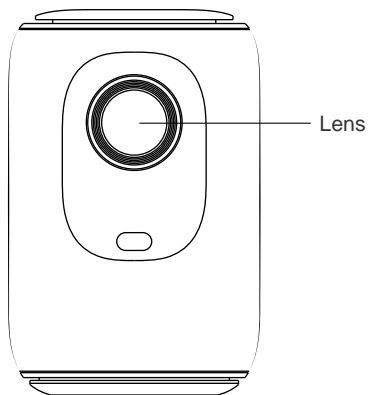

Power

Front View

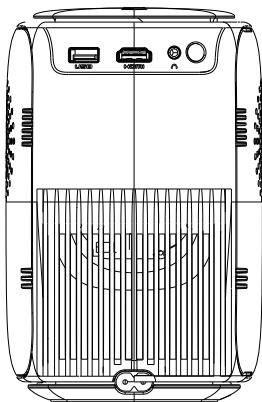

Rear View



USB



HDMI



Headphone



Power Input

REMOTE CONTROL

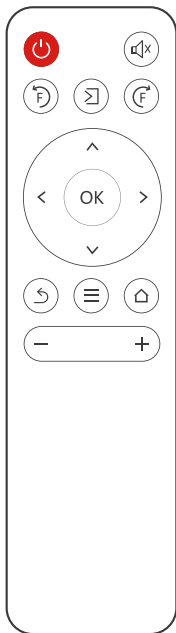

Power button:
Turn on/off



Mute button:
Mute



Focus button:
Adjust focal distance



Signal source button:
Choose to enter the Application Center, HDMI



Return button:
return to last step



Menu button:
enter the setting page



Home button:
short press and return to the homepage



Direction Buttons:
● Up ● Down
● Left ● Right
● OK



Volume button:
Volume-, Volume+

Installation of the remote control

1. Install 2 pieces of AAA batteries into the remote before using it. Do not combine new batteries with old ones in a remote controller, which can cause operation failure due to insufficient power supply.
2. When using the remote controller, please make sure that the signal transmitter of the remote controller aims at the infrared signal receiver of the projector.

QUICK START

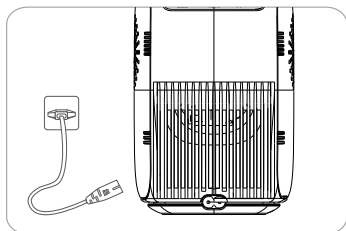

1. Plug the power cord into an outlet

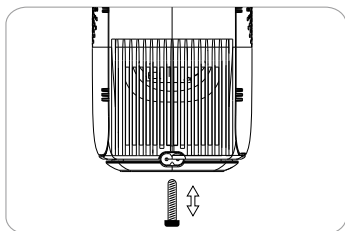

2. Adjust the kickstand accordingly

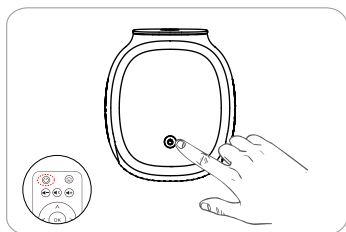

3. Press the power button to turn on the projector

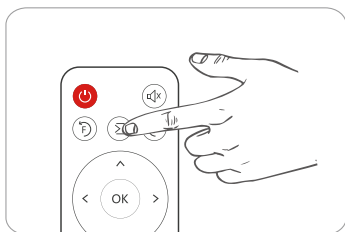

4. Select the correct input source to project your device.

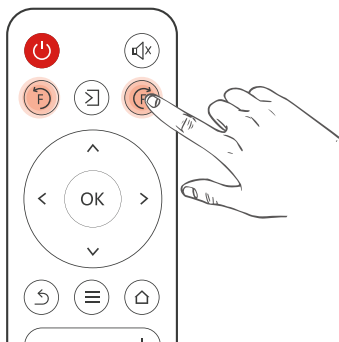

Press the button F+ or F- on the remote, a focus indicator will appear on the image. Please adjust according to the focus ring to get the best image performance.

INPUT SOURCE

Press on this button  on the projector remote to enter the interface of input source.

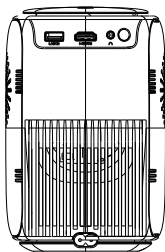

HDMI Connection

When the HDMI cable is plugged in, press the button  on the remote and select the [HDMI] mode, then select [HDMI] from the homepage to play the video.

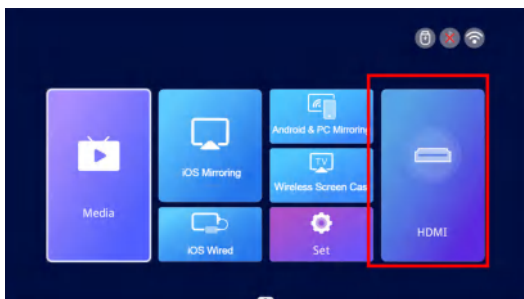
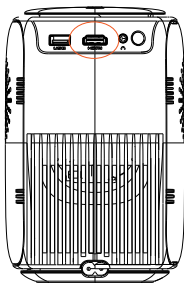

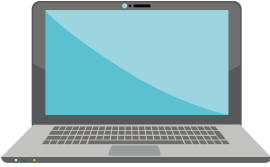

USB Connection

When the U disk is plugged in, and entering the Media, you can play any document in your USB disk.

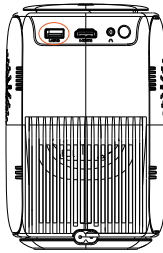

Insert U disk

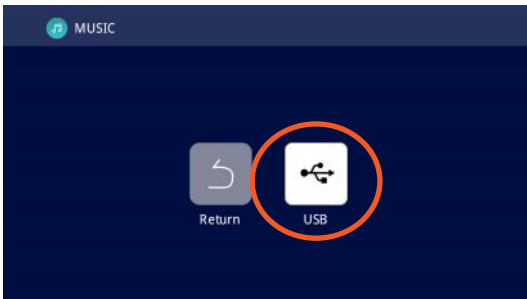

Speaker/Headphones Connection

Directly connect the wired speaker and your headphones/earphones to the Audio Out port on the projector with a 3.5mm audio cable.

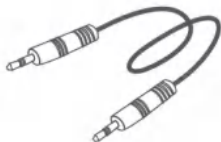
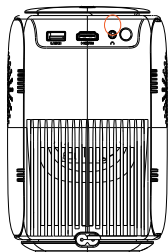

WIRELESS PROJECTION

Warming Tips:

- ① The fluency of screen mirroring with wireless connection will be affected by the network environment. A bandwidth of 100Mbit or more is recommended when using screen mirroring.
- ② Make sure your mobile device is close to the projector when using wireless connection. A distance within 1 meter is recommended.
- ③ Some mobile devices may not support screen mirroring due to the compatibility.
- ④ Any questions, please feel free to email Onoayo via

US: Support_us@onoayo.net

Step 1 : Connect Projector to your Home WiFi

Go to set page -- Select the [Network Setting] Select your home WiFi from the list -- Connect the projector to your home WiFi.

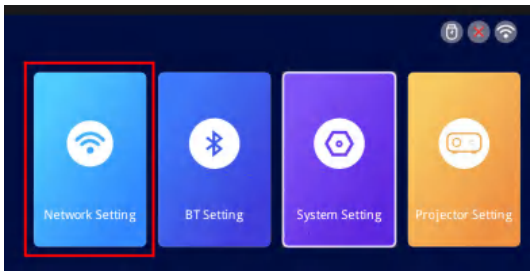
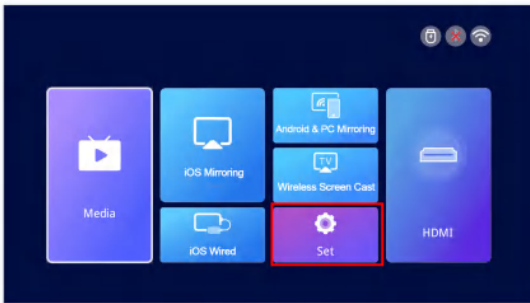



For iOS Devices:

Step1: Connect the projector and your iOS device to the same WiFi.

Step2: Go to Homepage of the projector and select [iOS Mirroring] to enter the screen mirroring interface.

Step3: Go to the Control Center of your iOS device and select Screen Mirroring.

Step4: Select the device name that appears on the projector screen from the searching list.

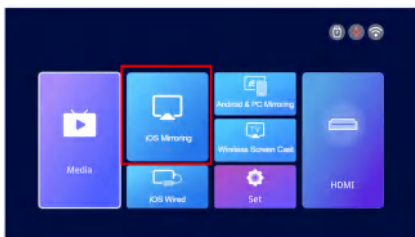

For Android&PC Devices

Step1: Connect your Android device or PC and projector to the same WiFi.

Step2: Go to Homepage of the projector and select [Android&PC Mirroring] to enter the screen mirroring interface.

Step3: Go to the Control Center of your Android device or PC and select Screen Mirroring.

Step4:Select the device name that appears on the projector screen from the searching list.

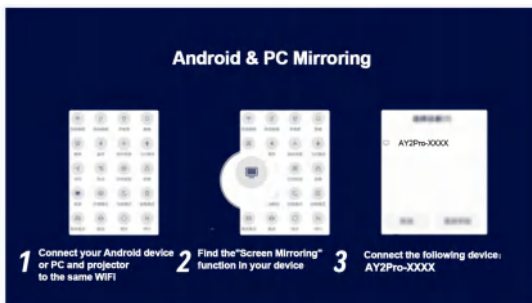
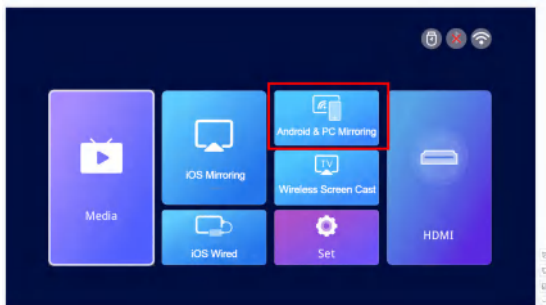

For iOS Cable devices

Step1: Go to Homepage of the projector and select [iOS Wired] to enter the screen mirroring interface.

Step2: Connect iOS device to device projection using a data cable.

Step3: In the POP-up window on the iOS device,select 'Trust'

Step4: If there is a password on the iOS device,enter the password and Start the same screen.

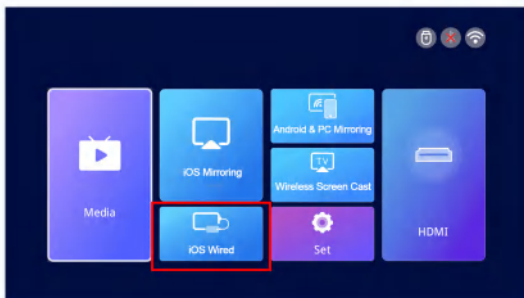

For APP Screen Cast

Step1: Please keep your device and projector on the same network.

Step2: Go to Homepage of the projector and select [Wireless Screen Cast] to enter the screen mirroring interface.

Step3: Open the screen projection app

Step4: Find the "Screen Cast" or "Wireless Projection" button

Step5: Then select the device name that appears on the projector screen from the searching list.

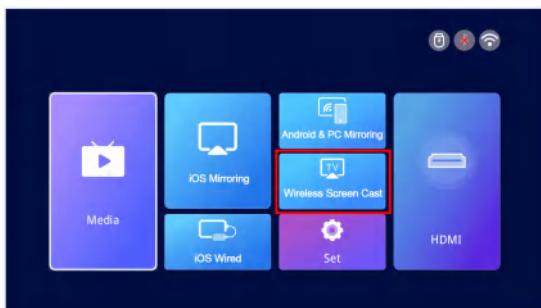

SETTINGS

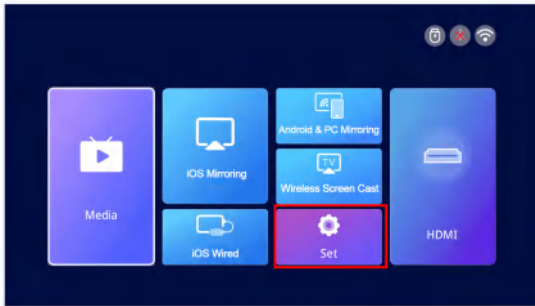

Menu	Menu2	Options	Functions
Network Setting	WIFI	/	Wifi Connection
BT setting	Bluetooth	Bt transmission mode/ Bt reception mode	Bluetooth Connection
Projector Settings	Flip mode	Desktop/Desktop rear/ Ceilingrear/Ceiling	Adjust projection mode
	Auto keystone	on/off	Adjust shape
	Horizontal calibration	-50~50[Reflects the degree of automatic adjustment in automatic trapezoidal mode]	Automatic adjustment
	Manual trapezoid	on/off	Adjust shape
	Image mode	standard/user/dynam- ic/mild	Adjust picture mode
	Sound mode	standard/music/Movie/ user/sport	
	Zoom	80%~100%	Zoom screen
System Settings	Language	English/Chinese/French /German/Japanese/ spanish/Italian	Adjusting language setting
	Local update	OK	Update version via USB flash drive
	Online update	OK	Update version via Online
	Software version	/	
	Restore factory default	OK	

BLUETOOTH CONNECTION

Go to the home page, click the “ Set ” to go to the Setting page. Choose the [BT Setting] to enter the BT function.

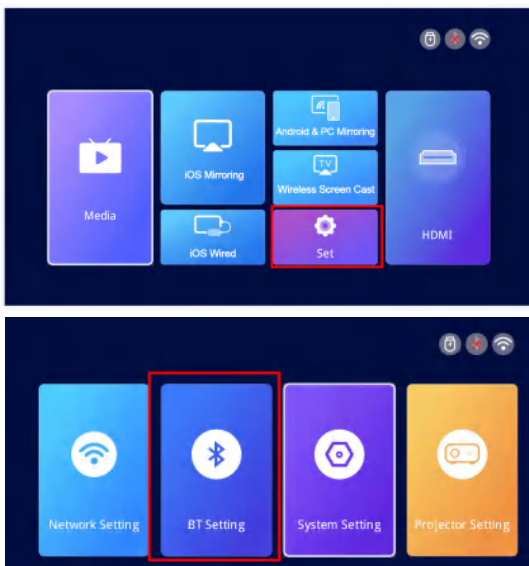

1. Connect the projector to an exterior Bluetooth speaker.

On the BT Setting page, Choose the Bt transmission mode and Press OK button to turn on the BT and scan for available devices. Choose the rightBluetooth device name, Press OK button to pair.

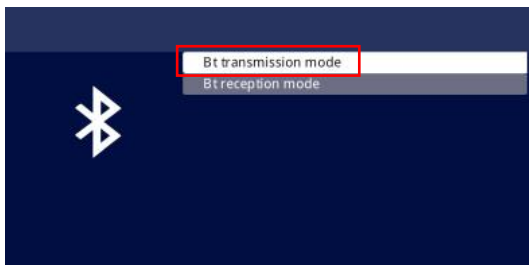



2. Connect your phone to the projector using Bluetooth.

On the Bluetooth settings page, Choose the Bt reception mode and wait on this page. Then use your phone to search and scan for available devices, Choose the right Bluetooth device name, Press OK button to pair.

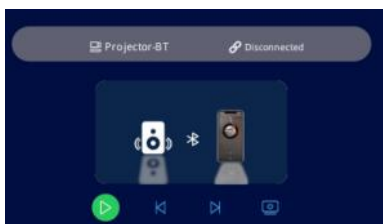
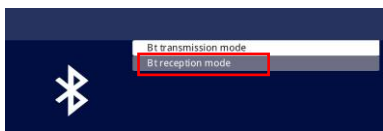

3. Cannot connect Bluetooth speaker?

When the Bluetooth speaker is connected to the projector, it will show up in paired devices ,it means that the projector has been successfully connected. If it shows pairing failed, it means that the Bluetooth speaker has not been connected to the projector.

Please try the following methods:

Method 1: Please click the [UNPAIR] , then connect your BT again.

Method 2: Operate on the projector to turn off Bluetooth (press the "OK" button on the remote control).

Then turn on BT (the "OK" button on the remote control). Reconnect the Bluetooth speaker again.

Method 3: Turn off the projector and restart it, then reconnect the Bluetooth speaker.

Method 4: Restore the factory settings and then reconnect the Bluetooth speakers.

If you tried the above methods but still can not solve your problem, please contact our customer service team to get a more specified checking and instruction. We promise that you will get a satisfactory solution.

US: Support_us@onoayo.net

4.Audio Delay After Connecting Bluetooth?

If you have an audio delay after connecting Bluetooth, you can try a different connection method, which is: Connect your Bluetooth speaker with your phones(or iPads, laptops) first, and then connect your phones with our projector. Please refer to the following pictures.

Please note: Due to Apple protocols, Apple devices do not support connecting a mobile phone to a Bluetooth speaker and then sharing the screen.

Connection methods that may cause sound delay ⚠️

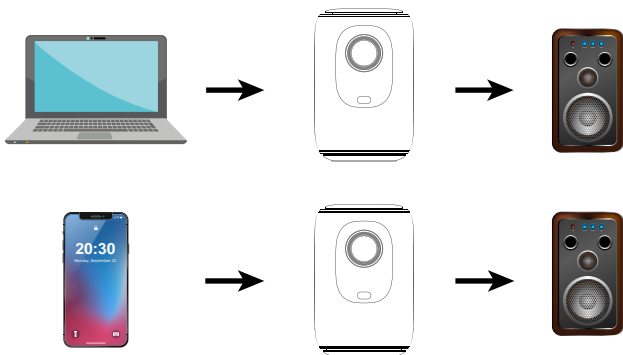

Recommended connection method ✅





PROJECTOR IMAGE SETTING

Installation Method

The projector support front and rear projection, it can be table mounted and ceiling mounted. To set the projection mode, go to the homepage. Click on the “Set” and find “Projector Setting”. You can see the “Flip Mode” option, press the left and right button to change to your desired mode.

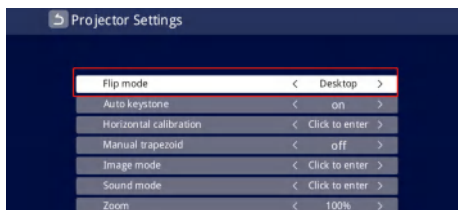
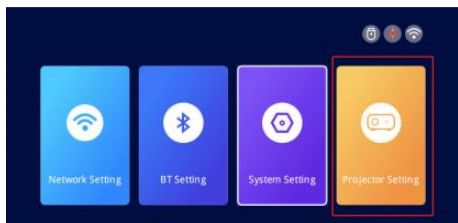
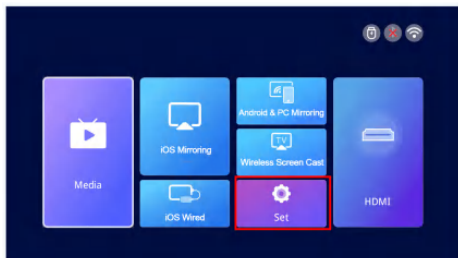

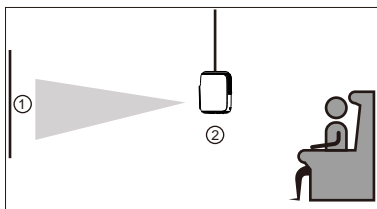

Front/ceiling

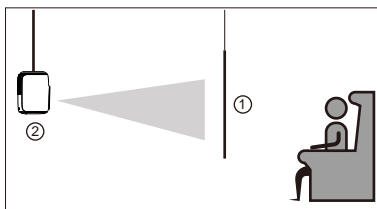

Rear/ceiling

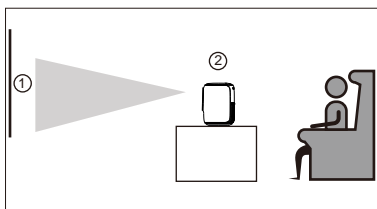

Front

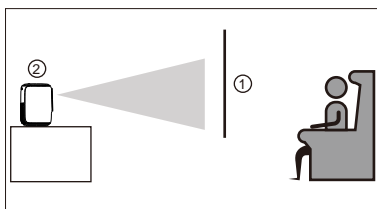

Rear

Auto & Manual Vertical Keystone Correction & Electric-focus & Zoom Function

Go to the setting page. Click on the "Projector Setting" then you can see every option about the adjustment.

>> Auto $\pm 50^\circ$ Vertical Keystone Correction

For auto vertical keystone correction, simply keep the interface "Auto Keystone" in the "on" state, and the projector will automatically correct the image distortion.

>> Manual $\pm 50^\circ$ Vertical Keystone Correction

If you prefer manual keystone correction, you can disable the automatic feature, keep it in the "off" state. After that, the "Manual Trapezoid" will show "on" state then you can adjust the keystone correction degree using the left and right buttons on the remote control.

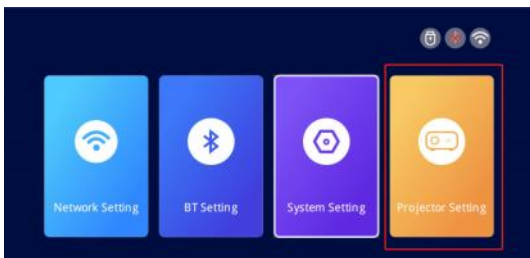
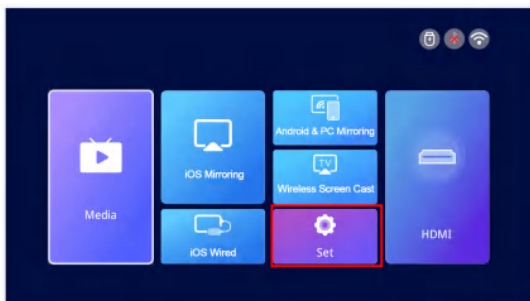

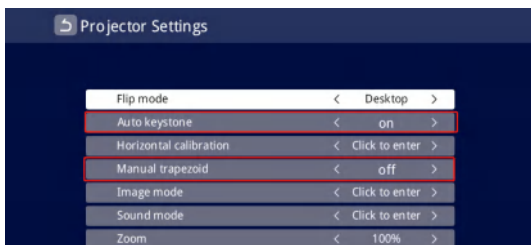

>> Electric-focus

① This mini projector only support electric-focus with remote control, just need to press the "Ⓜ" "&" "Ⓧ" on the remote.

② Note: Projector and screen/wall must be in effective distance.

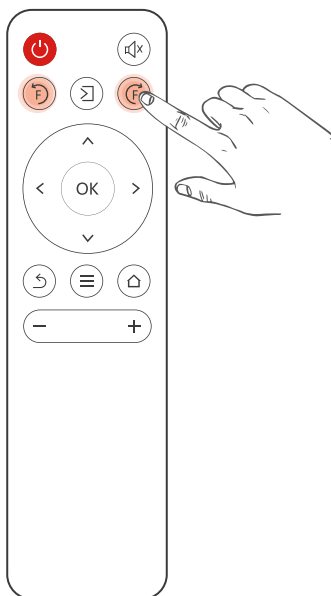

>> Zoom Function

Go to the setting page. Click on the "Projector Setting" then you can see the "zoom" adjustment. The projector supports 80%-100% zoom adjustment.

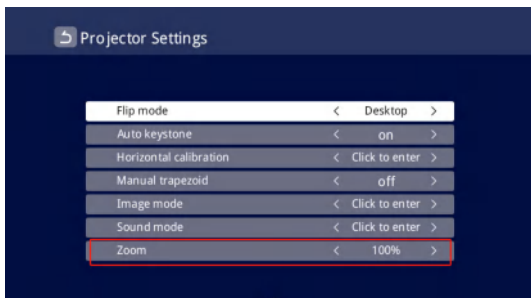
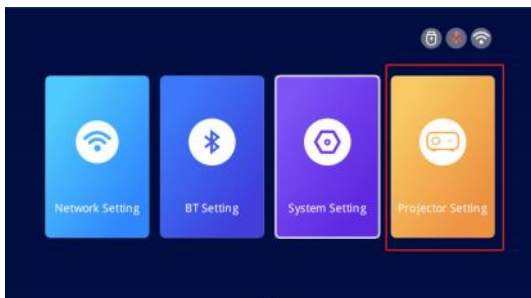
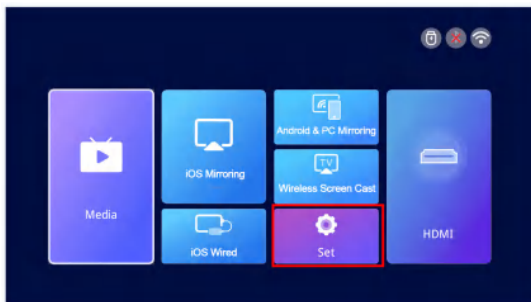

INSTALLATION

Projection Distance and Size

If you want to get a free projection screen, please email us via

US: Support_us@onoayo.net

Please follow the data in chart below, to adjust the image size and the distance.

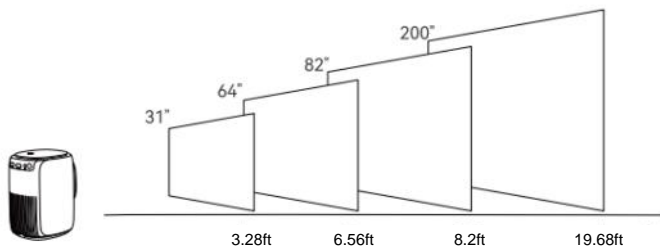

Please note:

1. The best image quality would be achieved with a projection distance of 3.28ft-19.68ft. A larger screen size would affect the image quality in a certain degree.
2. The image size depends on the distance between projector and screen, there may be 3% deviation among above listed data. Different settings cause various distances.

Projector Installation

• Desktop use

① attachment bracket

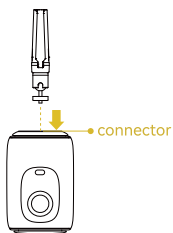

② Rotate the bracket until it is fixed.



③ Installation completed

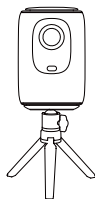

• Hoisting and use

① attachment bracket

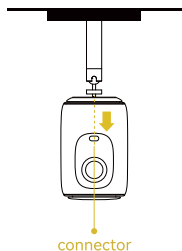

② Rotate the machine to a fixed position.

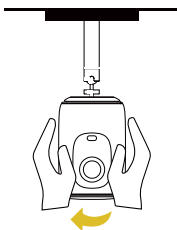

③ Installation completed

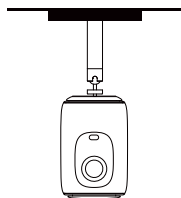

• Fixed Hanger Screw Hole Type: 1/4 inch threaded hole

Note: The above brackets are not included with the machine, and are for illustration only.

PROJECTOR SPECIFICATIONS

Imaging technology	TFT LCD
Native resolution	1920*1080
Light source	LED
Focus mode	Electronic focus
Projection distance	3.28-19.68ft;
Screen size	31-200 inches
Asoect ratio	16: 9 and 4: 3 and Auto-fit
Power input	100V-240V-50/60HZ
Input	USB*1/HDMI*1
Output	Earphone
Speaker	4Ω3W*2
Unit size	116*136*178mm
Net Weight	1.1KG
Throw Ratio	1.4:1

*Any buyer with any questions who comes to contact us will have our promise to get a satisfactory solution + an Extra 6 Month Warranty+other surprises to thanks for your support!

US: Support_us@onoayo.net

Official website: www.hdprojectortech.com

FCC STATEMENT:

This device complies with Part 15 of the FCC Rules. Operation is subject to the following two conditions:

- (1) This device may not cause harmful interference, and
- (2) This device must accept any interference received, including interference that may cause undesired operation.

Warning: Changes or modifications not expressly approved by the party responsible for compliance could void the user's authority to operate the equipment.

NOTE:

This equipment has been tested and found to comply with the limits for a Class B digital device, pursuant to Part 15 of the FCC Rules. These limits are designed to provide reasonable protection against harmful interference in a residential installation. This equipment generates uses and can radiate radio frequency energy and, if not installed and used in accordance with the instructions, may cause harmful interference to radio communications.

However, there is no guarantee that interference will not occur in a particular installation. If this equipment does cause harmful interference to radio or television reception, which can be determined by turning the equipment off and on, the user is encouraged to try to correct the interference by one or more of the following measures: Reorient or relocate the receiving antenna. Increase the separation between the equipment and receiver. Connect the equipment into an outlet on a circuit different from that to which the receiver is connected.

Consult the dealer or an experienced radio/TV technician for help.

FCC Radiation Exposure Statement:

This equipment complies with FCC radiation exposure limits set forth for an uncontrolled environment. This equipment should be installed and operated with minimum distance 20cm between the radiator & your body.

ONOA.YO